

仙臺鹽務局

中村出張所之部
(松ヶ江)

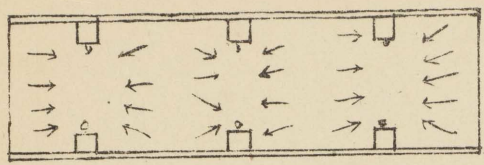

撒砂ノ集散

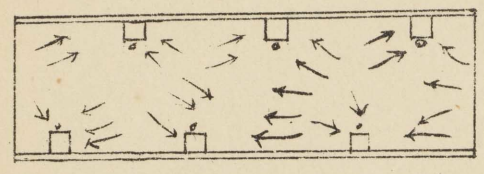
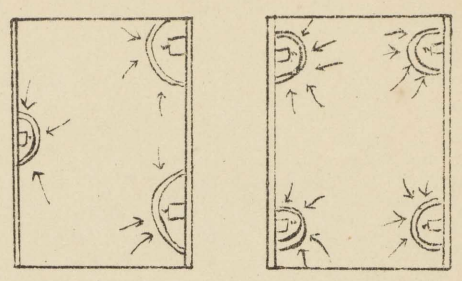

釜屋

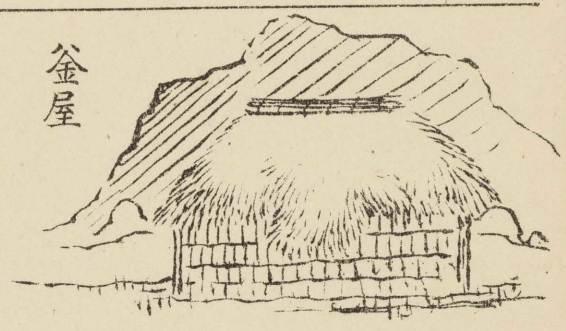

釜屋内部配置

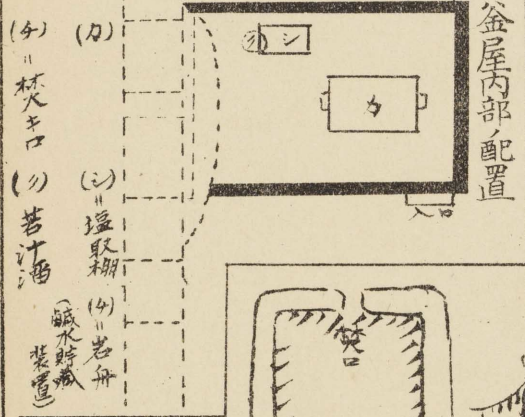

- (1) 杖火口
- (2) 塩取棚
- (3) 釜
- (4) 岩舟
- (5) 鹹水貯藏装置

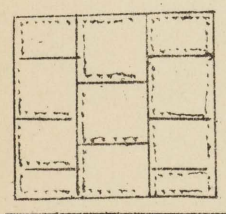
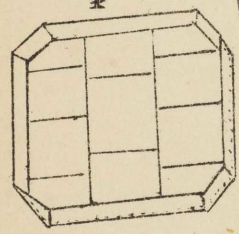
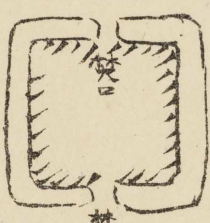

包装

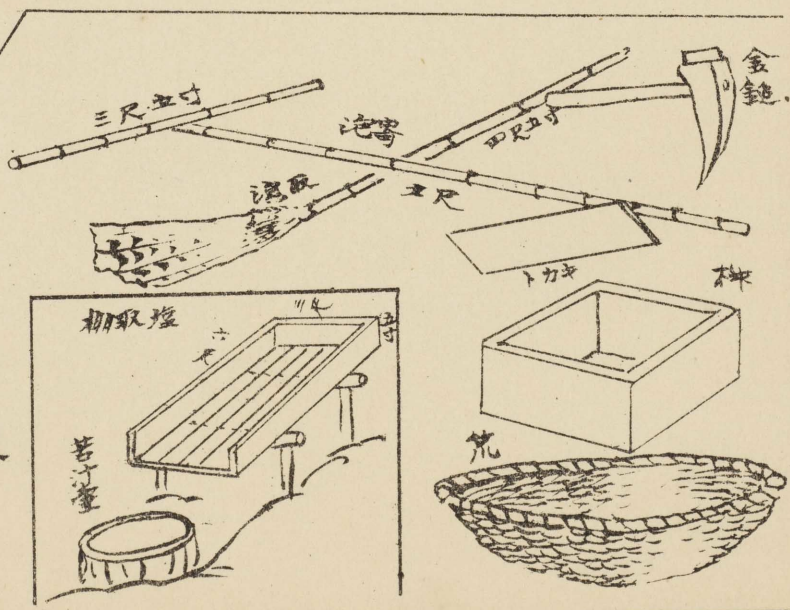
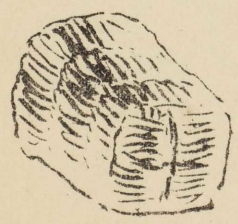

三尺五寸

泡膏

四尺五寸

金鍬

棚取塩

苦子釜

